

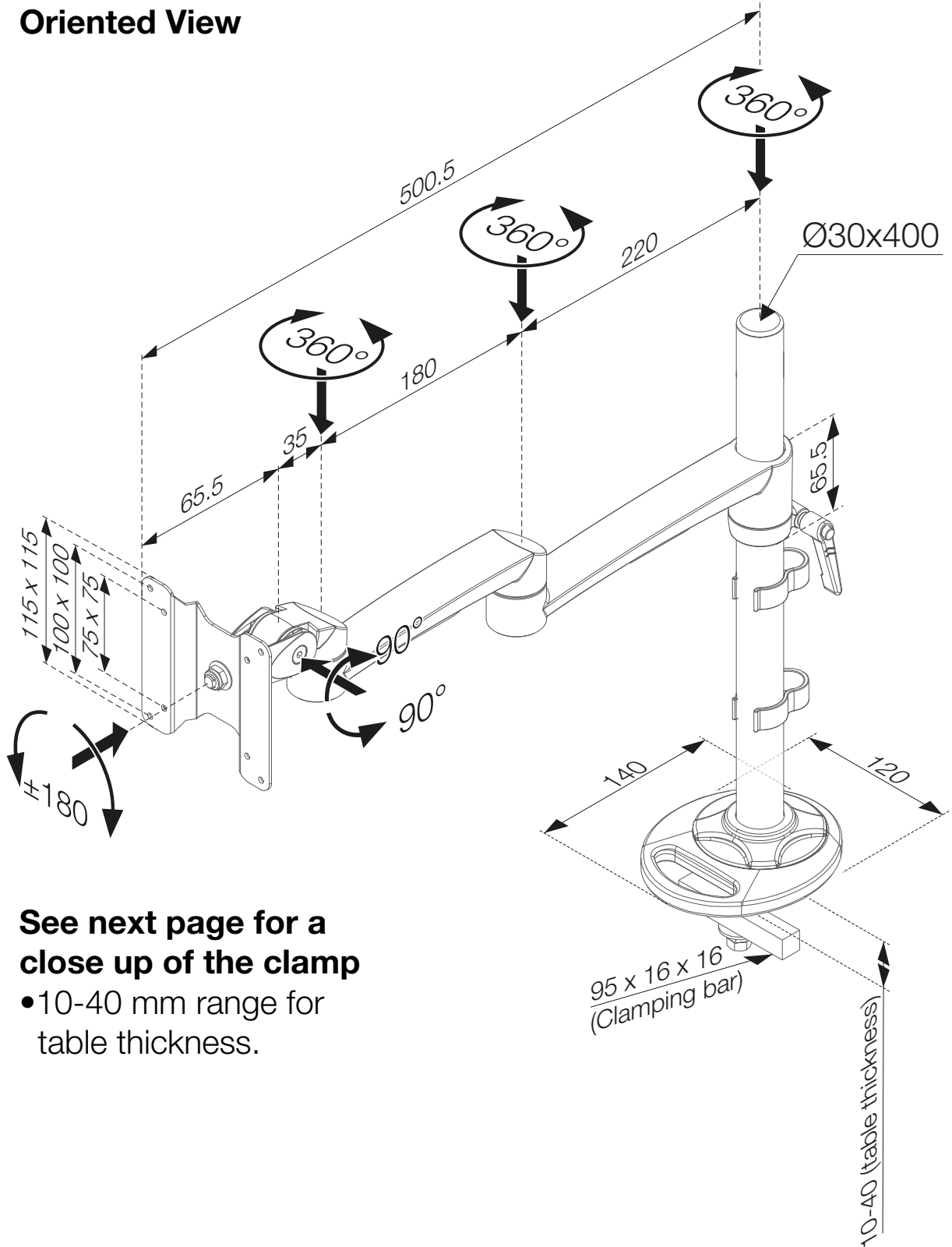

- 438-LC26
- 438-LC26W
- 438-LC26B

## Monitor Arm Oslo with grommet mount

### Oriented View



**See next page for a close up of the clamp**

- 10-40 mm range for table thickness.



- 438-LC26
- 438-LC26W
- 438-LC26B

## Monitor Arm Oslo with grommet mount

### Oriented View

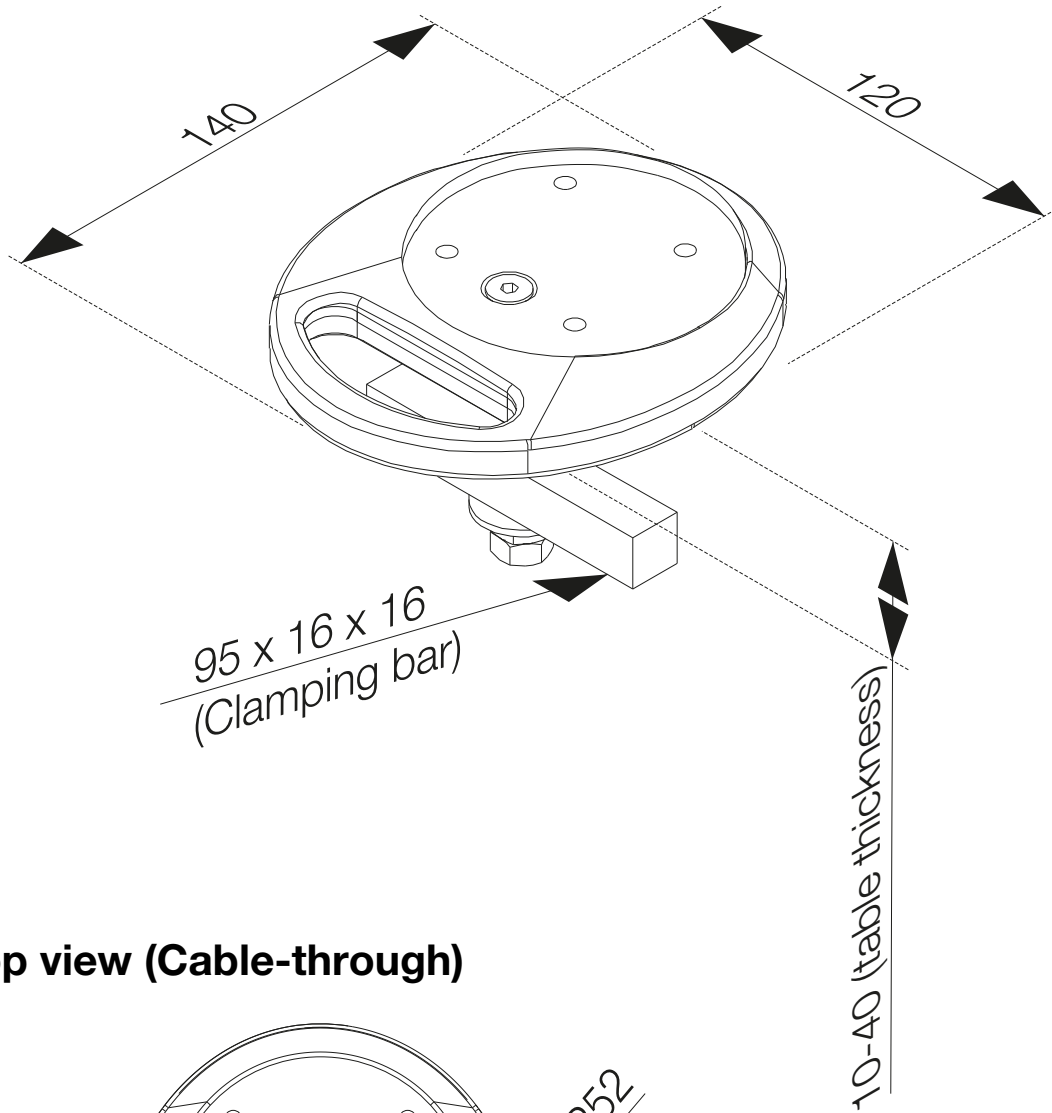

### Top view (Cable-through)

